

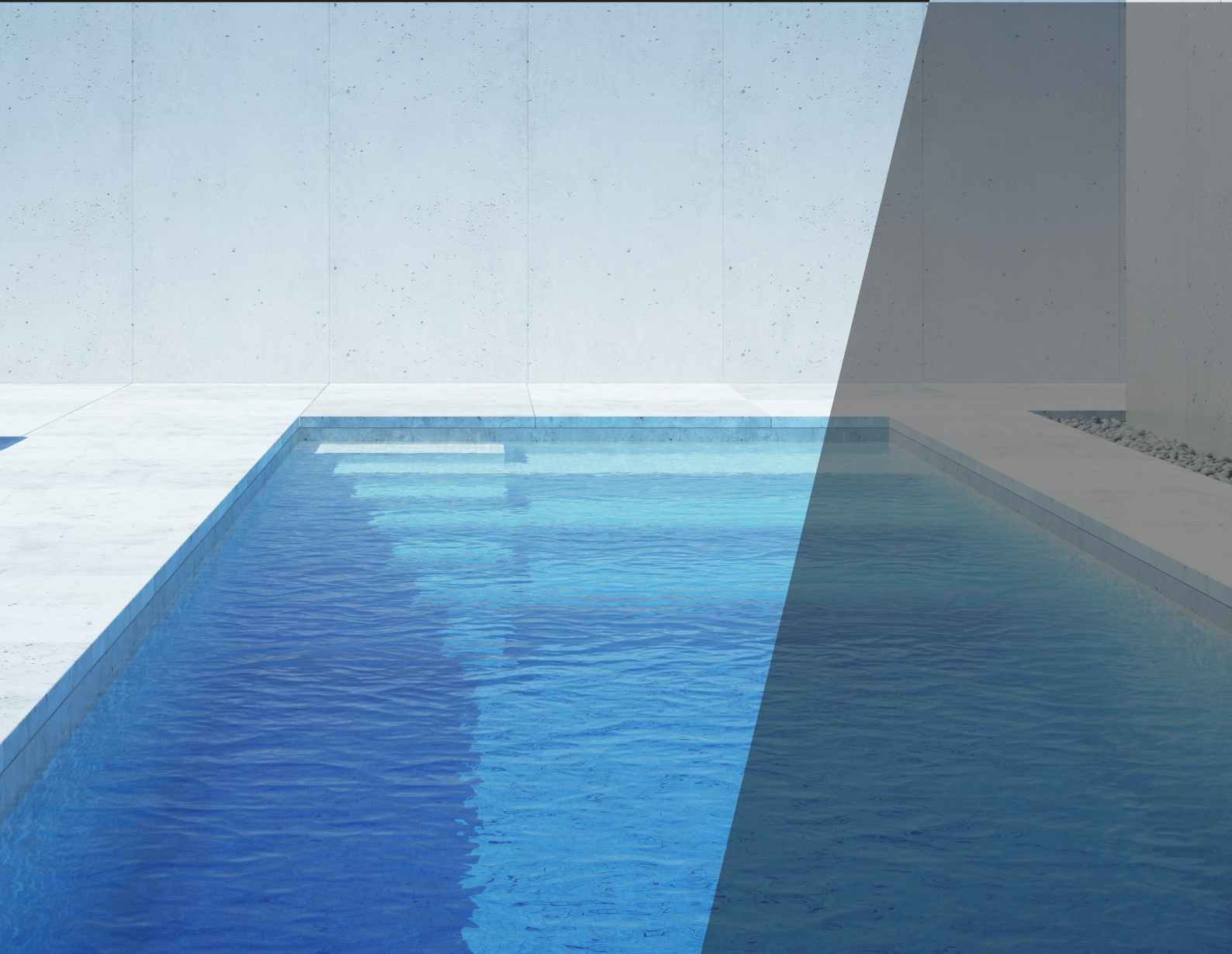

# GENERAL POOL CARE GUIDE

**EPOTREAD AQ-1**



**T: 0800 542 542**  
**W: [www.regiscoatings.co.nz](http://www.regiscoatings.co.nz)**

Revised: June 2023



This guide has been prepared to answer common questions and help you get the best performance and longest life from your newly coated pool.

## CARING FOR YOUR NEW SURFACE

### Be cautious during the first few months

The freshly coated surface can be a little slippery when wet. As the coating seasons over the first 3-6 months, this slipperiness reduces.

### Early rain or moisture after the coating has cured for 24 hours but before full cure.

A temporary milky or cloudy appearance may develop (known as surface bloom). This sits on top of the coating rather than within it and does not affect durability.

- It can usually be removed by scrubbing with a plastic scouring pad (e.g. Scotch-Brite®) and a mild abrasive cleaner (Bar Keepers Friend, Jif, etc.), or
- If it is not possible to remove as above, apply a further coat to the area.

### Leaves, bugs, or debris

That have dried onto the surface can generally be removed after approximately 5 days by gentle scraping. Leaf staining will typically fade once the pool is filled and chlorinated.

## FILLING THE POOL

It is important to allow 14 days of good drying conditions for the final coat to fully cure, before filling the pool with water. Incomplete curing can lead to colour pigment rub off when pool is in use.

### Summer

Fill the pool and super-chlorinate for the first two nights. Vacuum any sediment and run filtration continuously until water becomes fully clear (approx. 24 hours). Add salt to saltwater pools once full.

### Winter

These steps can be delayed up to 7 days after filling.

## IMPORTANT INFORMATION

All epoxy coatings will gradually chalk over time when exposed to UV sunlight. This is normal. With a good pool cover, correct water chemistry and routine maintenance, chalking can be minimised and the coating's life maximised. It is essential that any pool shop or technician managing your water chemistry knows that your pool has a painted epoxy surface and that chemical levels must be kept within the following limits.

## CHEMICAL BALANCE GUIDELINES

### Total Alkalinity (TA)

Target 160-180 ppm and allow initial levels of ~180 ppm to slowly reduce. As a guide: ~1 kg bicarbonate soda per 5,500 L fresh water (11 kg per 61,000 L, 13.5 kg per 75,000 L).

### Low TA Symptoms

This will cause a white powdery deposit on the pool surface. Colour transfer to skin or feet when rubbed. Continued abrasion from feet etc on this powder layer can shorten the coating's life due to the abrasiveness of the chalk.

### pH

Maintain between 7.6 - 7.8.

### Chlorine

Keep levels as low as practical while maintaining hygiene – ideally 1-2 ppm (not above 3 ppm).

### Calcium Hardness

Should be maintained between 280-320 ppm.

Parameter	Ideal Range
Total Alkalinity (TA)	160 - 180 ppm
pH	7.6 - 7.8
Calcium Hardness	280-320 ppm
Free Chlorine	1-2 ppm

## RAINWATER

Collected rainwater in pools is commonly done in NZ. This water is generally soft and slightly acidic (low pH), which can affect your pool's chemical balance and in particular, TA levels.

### Contamination

Rainwater can pick up dust, debris, bird droppings, and other contaminants from the roof and air. A proper collection system with filters and a first-flush diverter is necessary to minimise this.

### Chemical Balance

The pool water will require disinfection and pH balancing after adding rainwater. The pH should be adjusted to about 7.5, and a sufficient free residual chlorine level maintained.

## CLEANING & ONGOING CARE

Just like washing and polishing a car prolongs its finish, regular brushing of walls and floor is recommended:

- Monthly in summer
- Every 6-8 weeks during cooler months

Brush vigorously, then filter for 8 hours to remove loosened particles. This helps prevent algae growth and surface chalking.

Chalking is a natural process during the life of the epoxy coating and is not a result of any defect in the paint or material used in the manufacture of the paint. To minimise it, maintain TA at 160-180 ppm year-round.

### Sand Filters

Chalk particles are very fine and may pass through sand. Options: Allow dust to settle then vacuum to waste.

### Robotic cleaners with hard wheels

These can accelerate wear. Seek softer-wheel alternatives if possible.

## USEFUL TIPS

- If using stabiliser (cyanuric acid), do not exceed 55 ppm. Higher levels can skew TA results.
- Do not confuse TA with pH. They measure different aspects of water balance.
- If a chalky film becomes noticeable, wrap a pool broom with elastic bandage and thoroughly brush all surfaces. Filter for up to 8 hours and backwash. Re-dose TA back to 180 ppm afterward.
- NZ's stronger UV and milder winters mean pools are rarely emptied. Making ongoing TA control more important here than in many overseas guidelines.
- When seeking chemical advice, ensure you inform advisor that your pool is EPOXY PAINTED (not fibreglass, concrete, or plaster). Incorrect classification often leads to TA being kept too low and faster surface wear.

## ENJOY YOUR NEW POOL

With correct care and balanced water chemistry, your Epotread AQ-1 Epoxy Coating will provide long-lasting appearance, durability, and swimming enjoyment for many years to come.

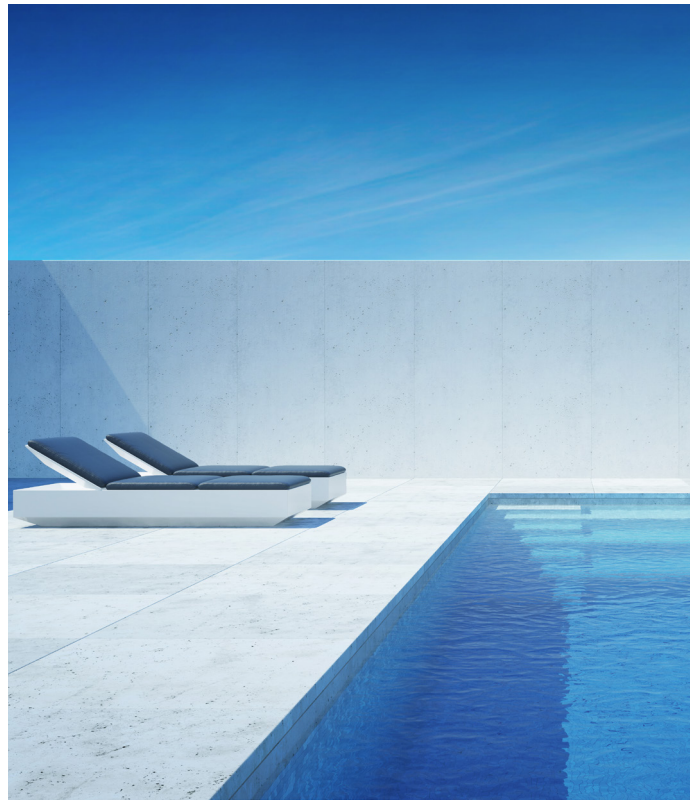

## DISCLAIMER

The information provided in this technical bulletin is as up-to-date and correct in detail as possible and is intended to give a fair description of the product and its capabilities. The user of these materials must satisfy themselves with the suitability for a particular application. Pool chemistry and maintenance is outside our control and is the responsibility of the customer. If unsure about use with certain chemicals, please contact the manufacturer.

---

## **REGIS COATINGS LTD**

127 Antigua Street  
Addington  
Christchurch 8024

Freephone: 0800 542 542  
Email: [sales@regiscoatings.co.nz](mailto:sales@regiscoatings.co.nz)



[regiscoatings.co.nz](http://regiscoatings.co.nz)

